

# IN5300 (SERIES)

**InFocus**  
Bright Ideas Made Brilliant

## Star Quality

Ease of Use - Sophisticated Features  
Elegant Styling - Stunning Image Quality

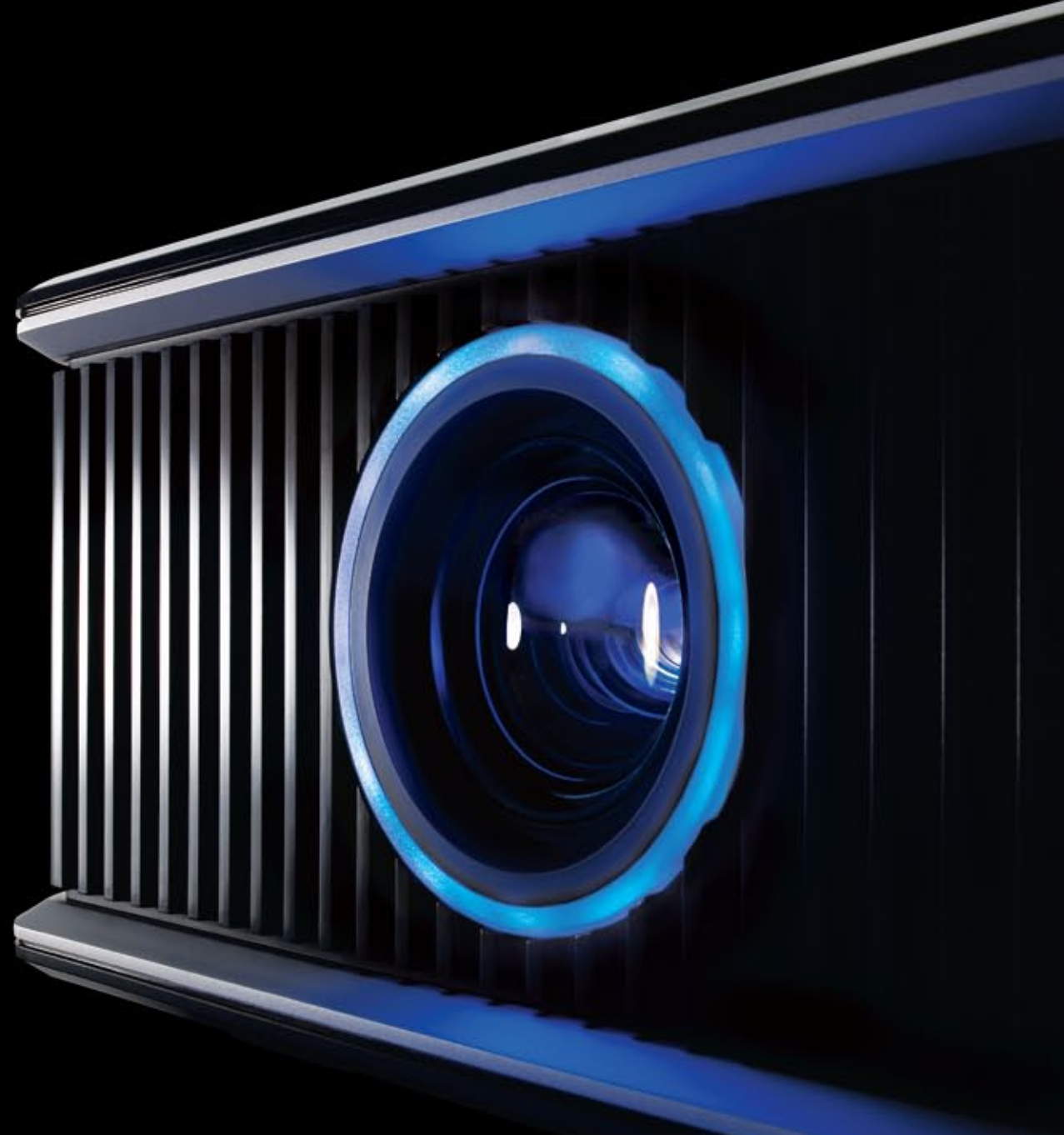

# IN5300 (SERIES)

## Lasting brightness and color that stays.

The InFocus IN5300 series delivers superior visual performance with DLP® DarkChip™ Technology, finely tuned with our own BrilliantColor™ enhancement, a maximum brightness of 4000 lumens, and up to WXGA (1280 × 800) resolution for true-to-life images in vivid detail. The optical lens shift allows for install flexibility, while DisplayLink™ provides instant set-up and hassle-free projection over USB. The series is network-ready and supports full analog and HD video connectivity. From complex spreadsheets to web-based content to HD video, the new InFocus IN5300 series brings star quality to every performance.



### IN5302

XGA (1024 × 768)  
DLP DARKCHIP

The InFocus IN5302 is the ideal XGA upgrade projector for facilities which have older XGA technology. The perfect cost effective alternative integrating DLP reliability to your existing projection system.

### IN5304

WXGA (1280 × 800)  
DLP DARKCHIP

The InFocus IN5304 is the perfect WXGA enhancement projector for facilities that are looking to move to the new world of wide projection/images/visuals. The IN5304 embraces the new wide format standard in personal computers and video content.

### Custom Skins

Choose your cover. With options in Matte Black, Matte White, Glossy Black, Walnut, or pre-primed custom skins, the IN5300 series blends beautifully with any décor.



### Digital, Brilliant Color

The IN5300 series delivers a stunning combination of HD resolution and vivid detail in true-to-life colors with the latest DLP DarkChip technology and InFocus award-winning BrilliantColor implementation. For lasting brightness and color that stays.

### High Resolution XGA/WXGA

Designed for optimal flexibility, the IN5300 series is available in widescreen WXGA (1280 × 800) resolution to match the new wide format standard in personal computers and video content, or XGA (1024 × 768) resolution for legacy installations.



XGA  
1,024 x 768 PIXELS

WXGA  
1,280 x 800 PIXELS



*“The days of staring at an industrial looking box with cables on the ceiling has officially ended.”*

Benjamin Joy  
InFocus Product Director

### Rich Connectivity

The IN5300 series features full analog connectivity with HD15, BNC and component inputs, and HDMI 1.3 for the latest in Computer and HD Video connectivity. Engineered to be Wireless-Ready with LiteShow II™, the IN5300 series also includes embedded networking and RS232 control for full projector management.

### Unique “Blue Iris” Glow Ring

The exclusive InFocus “Blue Iris” glow ring notifies users - from experienced to novice - when the projector is powering up or down. No more guessing the status of the projector.

### 24/7 Non-Stop Projection

All new InFocus DLP projectors are filter-free and are rated for 24/7 fail-safe operation, resulting in less maintenance and hours of worry-free use.

### Crystal Clear Glass

Masterfully crafted glass lenses provide crystal clear, uniform and precise images.

### LiteShow II

The InFocus LiteShow II wireless adapter connects personal computers to InFocus digital projectors wirelessly. The high bandwidth 802.11 b/g connection supports simultaneous transmission of audio along with video/data content, providing a completely wireless multimedia presentation.

### LiteTouch™ Keypad

The sleek backlit LiteTouch control panel provides one-touch access to the most commonly used projector functions.

### High Performance Optics

Built-in horizontal and vertical lens shift allows mechanical alignment without optical distortion to retrofit legacy installations. Automatic sensors for ceiling detection and keystone means you will have a crisp, square image everytime. Pincushion and Barrel Distortion is eliminated, enabling the IN5300 series to project perfect images even on imperfect surfaces.

### Projector Management

Control at your fingertips. The IN5300 series built-in web browser allows network administrators to remotely access and control the projector over standard LAN/WAN. The series is compatible with ProjectorNet™ 3.0, our free asset management software that enables you to conserve projector lamp life by scheduling On/Off times, and presetting maintenance events and anti-theft security alerts.

### Dynamic Messaging System

Send dynamic messages for instant display to InFocus projectors using the InFocus Dynamic Messaging System (DMS). Perfect for general and important announcements such as schedule changes, weather warnings, breaking news and emergency notifications.

### Horizontal and Vertical Lens Shift

Manual vertical shift - +5% to +30%  
Manual horizontal shift - +/-15% at 5% vertical offset

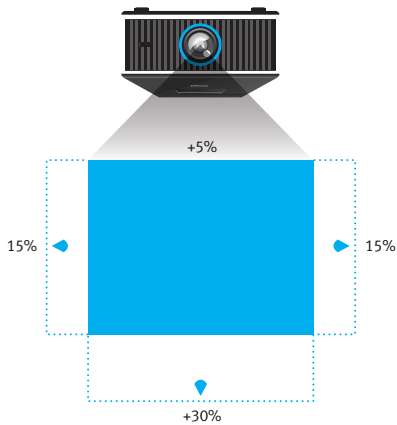

### Intuitive and Easy to Use Interface

Over 20 years of customer feedback has gone into designing the IN5300 series best-in-class menu system. It is easy to navigate, has 17 standard languages and a unique intuitive flow.

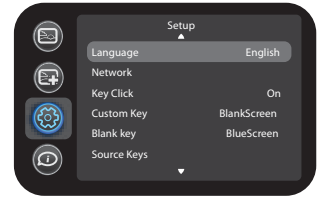

### Unique Cable Management System

The integrated cable management system provides easy access to the rich connector panel, while aligning each cable to the cable router. The result: 100% hidden cables that look as good as the rest of your room.



### SplitScreen™

Project images from 2 sources simultaneously and in a variety of configurations with InFocus SplitScreen technology. Perfect for viewing multiple presentations, videoconferencing and distance learning.



Unique Cable Management System

InFocus Optics Laboratory

## Optional Accessories

Security Lock (SEC-LOCK-01)  
 Replacement Lamp (SP-LAMP-053)  
 LiteShow II Wireless Adapter (INLITESHOW2)  
 Ceiling Mount (SP-CEIL-INSTALL)  
 Commander Remote (HW-COMMANDER-2)  
 Glossy Black Skin Kit (TOP-03-GB)  
 Matte White Skin Kit (TOP-03-MW)  
 Walnut Skin Kit (TOP-03-W)  
 Primer Skin Kit (TOP-03-B)  
 Projection Screens  
 Cables & Adaptors

For more information, please visit:  
[www.infocus.com/Accessories.aspx](http://www.infocus.com/Accessories.aspx)



## DisplayLink

Hassle-free, lightning fast-projection. DisplayLink Content over USB technology eliminates the need for bulky VGA cables and allows for computer and image set up in seconds without toggling or cumbersome function key combinations. DisplayLink makes projecting simple!

## Warranty

Providing the highest quality products and support is very important to InFocus. The new IN5300 series digital projectors come standard with a 5 year limited factory warranty (including parts<sup>1</sup> and labor<sup>2</sup>) a 6 month limited lamp replacement warranty and 5 year DLP warranty. Extended product and lamp warranty programs are also available.

For more information, please visit:  
[www.infocus.com/Support/Warranty.aspx](http://www.infocus.com/Support/Warranty.aspx)



## IN5300 (SERIES) FEATURES

- 2-3 Pull Down
- Auto Keystone
- BrilliantColor
- Cable Management System
- Centered Lens
- Closed Captioning
- Custom Skins
- DisplayLink Plug & Play (DDC2B)
- DMS Dynamic Messaging System
- Electrical H&V Keystone Correction
- Freeze Frame with Magnifying Function
- InFocus UI
- Lamp Door On Side
- LitePort™ USB JPEG Player
- LiteShow II Wireless Ready
- LiteTouch Touchsense Keypad
- Logo Capture
- Low Power Standby (<1W)
- Manual Focus and Zoom
- Manual Lens Shift
- Pincushion/Barrel Distortion Correction
- ProjectorNet™ Web Browser Control
- Sleep Timer
- SNMP Capable
- SplitScreen Dual Images



# InFocus

Bright Ideas Made Brilliant

[www.infocus.com](http://www.infocus.com)

**INFOCUS CORPORATE HEADQUARTERS**  
 13190 SW 68th Parkway  
 Portland, Oregon 97223-8368, USA  
 Phone: (1) 503-207-4700  
 Toll Free: (1) 877-388-8385  
 Fax: (1) 503-207-1937

**INTERNATIONAL HEADQUARTERS**  
 1 Fullerton Road  
 One Fullerton  
 Singapore 049213  
 Phone: (65) 6513-9600  
 Fax: (65) 6238-0535

©2010 InFocus Corporation. All rights reserved. Specifications are subject to change without further notice. InFocus and InFocus Bright Ideas Made Brilliant are either trademarks or registered trademarks of InFocus Corporation in the United States and other countries. DLP, the DLP logo, and the DLP medallion are trademarks of Texas Instruments. All trademarks are used with permission or are for identification purposes only and are the property of their respective companies.  
<sup>1</sup>Excludes power supply, fans, color wheel and light tunnel which are covered for two (2) years.  
<sup>2</sup>Labor is covered for two (2) years from date of proof of purchase.  
 InFocus\_IN5300\_DS\_EN\_05MAR10. Part Number: MMINFOCUS-0204

# Specifications\*

	IN5302	IN5304	
Native Resolution	IN5302 – XGA 1024 × 768 IN5304 – WXGA 1280 × 800	WUXGA (1920 × 1200)	
Maximum Resolution	IN5302 – DLP Technology .55" XGA DarkChip IN5304 – DLP Technology .65" WXGA DarkChip	4000 ANSI lm (Normal Mode) 3,200 lm (Eco Mode)	
Display Technology - DMD	Brightness	1500 Hrs	
Lamp Life**	Contrast Ratio	2300:1 Typical	
29 db Eco Mode (30 db High Power)	Audible Noise	29 db Eco Mode (30 db High Power)	
Computer Compatibility	PC, MAC		
Lenses (Std) - Focal Length	22.18 mm at f2.45 – 33.27 mm at f2.9		
- Focus Range	5' to greater than 30' (1.5 m to 5 m)		
	IN5302	IN5304	
	- Throw Ratio	1.62 ~ 2.64	1.57 ~ 2.39
	- Zoom Ratio	1.5:1	1.5:1
Lens Shift Type	Manual		
Lens Shift - Vertical	IN5302 & IN5304	+5% to +30%	
- Horizontal		+/- 15% at 5% Vertical Offset	
Colorwheel	RGBYW / 5 Segment		
Number of Colors	1.07 Billion		
Aspect Ratio	IN5302 – Native 4:3 IN5304 – Native 16:10		
Lamp Power	330 W		
Zoom/Focus	Manual Zoom, Manual Focus		
Synch - Horizontal Scan Freq	15 ~ 100 kHz (Video/PC)		
- Vertical Scan Freq	50 ~ 85 Hz (Video/PC)		
Video Compatibility	NTSC / PAL / SECAM / PAL-M, N / NTSC4.43		
	SDTV: 480i, 480p, 576i, 576p		
	HDTV: 720p, 1080i, 1080p (60,30,24Hz)		
Audio	5 W × 2		
Input Sources	15pin Dsub × 2, 5 BNC, DisplayLink, LitePort, HDMI 1.3 × 2, Component, S-Video, Composite, Stereo Mini × 2, RCA Stereo × 3		
Output Sources	15pin Dsub Stereo-Mini Jack × 1		
Control	2.5 mm Stereo Mini, Projector Keypad, IR Remote Control, USB, RS232, RJ45, Wired Remote		
Screen Trigger	3.5 mm Mini 12 VDC 250 ma		
Network	10 BASE-T, 100 BASE-TX		
Product Weight	16.76 lbs / 7.6 kg		
Product Dimensions - W×D×H	14.25 × 21.25 × 7.0 in / 362 × 540 × 178 mm		
Product Color	Matte Black, Glossy Black, Matte White, Walnut, Primer for Customization		
Shipping Dimension - W×D×H	27.5 × 19.5 × 12.32 in / 699 × 495 × 313 mm		
Shipping Weight	28.3 lbs / 12.8 kg		
Maximum Altitude	7,500 ft / 2286 m		
Remote Control	Navigator - 3		
Ships With - Accessories	RGB Cable, Power Cord, USB Mini-B to A, Remote, Safety Instruction, Projector User's Guide, Display Link User's Guide		
Menu Languages	English, French, German, Italian, Korean, Portuguese, Russian, Spanish, Traditional Chinese, Simplified Chinese, Norwegian, Swedish, Finnish, Danish, Dutch, Polish, Turkish		
Lamp Rupture Containment	Tested to larger than 0.8 mm ***		
Accessories Warranty	90 days		
Regulatory Model	M5300		
Approvals	UL60950-1/cUL (USA and Canada), FCC Part 15, Class A (USA), CE (Europe), NOM (Mexico), S-Mark (Argentina), GOST (Russia), KC (Korea), SAFETY Mark (Singapore), CCC, CECP (China), C-Tick (Australia/NZ)		
Security	Kensington Lock		

\* Product specifications, terms, and offerings are subject to change at any time without notice.  
 \*\* Actual lamp life may vary based on the ambient environment and projector usage. Conditions that may affect lamp life include temperature, altitude, and rapidly switching the projector on and off.  
 \*\*\* Tested to contain particles larger than the specified size in any dimension

